

Fig. No. 65000AP

All Purpose Basin Lavatory Legs for China or Iron Enamel Basin

Installation Instructions

These all purpose basin lavatory legs can be used in conjunction with china or iron enamel basins.

When using these legs on china basin, discard universal adapter, item (7B).

When using these legs on iron enamel basin, discard rubber hat washer, item (7A) and hex bell escutcheon, item (8) with screw, item (9).

1. Press in threaded top plug (2) into the hexagonal leg (1).
2. Press in pointed bottom plug (3) into other end of hexagonal leg (1).
3. Thread on square nut (6) onto one end of threaded rod (4) approximately 1½" from end of rod or as required.
4. Slip on round washer (5) over end of rod (4) and thread rod into threaded top plug (2).
5. a. For China Basin
Press on rubber has washer (7A) onto other open end of threaded rod (4) and discard universal adapter (7B).
b. For Iron Enamel Basin
Thread on universal adapter (7B) onto other open end of threaded rod (4) and discard rubber hat washer (7A) and hexagonal bell escutcheon (8).
6. For China Basin only slide on hexagonal bell escutcheon (8) onto hex leg (1) with round diameter facing upwards and screw (9) facing the side of hex leg (1).
7. Place completed leg assembly under the basin.
 - a. For China Basin
The rubber hat washer (7A) should fit into the hole on the underside of the basin.
 - b. For Iron Enamel Basin
The universal adapter (7B) should engage the protrusion on the underside of the basin.
8. Thread up the threaded rod (4) until there is sufficient tension on the hex leg (1).
9. For China Basin - Bring up hex bell escutcheon (8) to cover exposed rod and tighten screw (9).
10. Repeat the same steps on the second leg.

NOTE: When installing legs over a smooth tile floor, it is suggested that you drill a small diameter hole into the tile to permit the pointed end of the bottom plug (3) to anchor itself to the floor to prevent sliding.

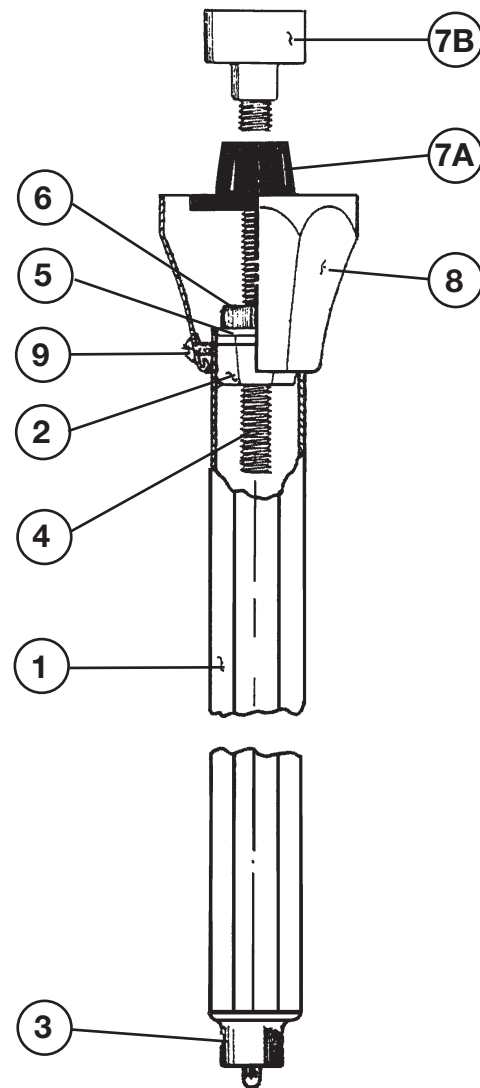

Fig. No. 650003

Basin Lavatory Legs for China Basin

Installation Instructions

1. Press in threaded top plug (2) into the hexagonal leg (1).
2. Press in pointed bottom plug (3) into other end of hexagonal leg (1).
3. Thread on square nut (6) onto one end of threaded rod (4) approximately 1 1/2" from end of rod or as required.
4. Slip on round washer (5) over end of rod (4) and thread rod into threaded top plug (2).
5. Press on rubber hat washer (7) onto other open end of threaded rod (4).
6. Slide on hex bell escutcheon (8) onto hex leg (1) with round diameter facing upward and screw (9) facing side of hex leg (8).
7. Place completed leg assembly under the china basin. Make sure that rubber hat washer (7) fits into the hole on the under-side of sink. Thread up the threaded rod (4) until there is sufficient tension on the hex leg (1).
8. Thread down square nut (6) and round washer (5) to lock assembly securely in place.
9. Bring up hex bell escutcheon (8) to cover exposed rod and tighten screw (9).
10. Repeat the same steps on the second leg.

NOTE: When installing legs over a smooth tile floor, it is suggested that you drill a small diameter hole into the tile to permit the pointed end of the bottom plug (3) to anchor itself to the floor to prevent sliding.

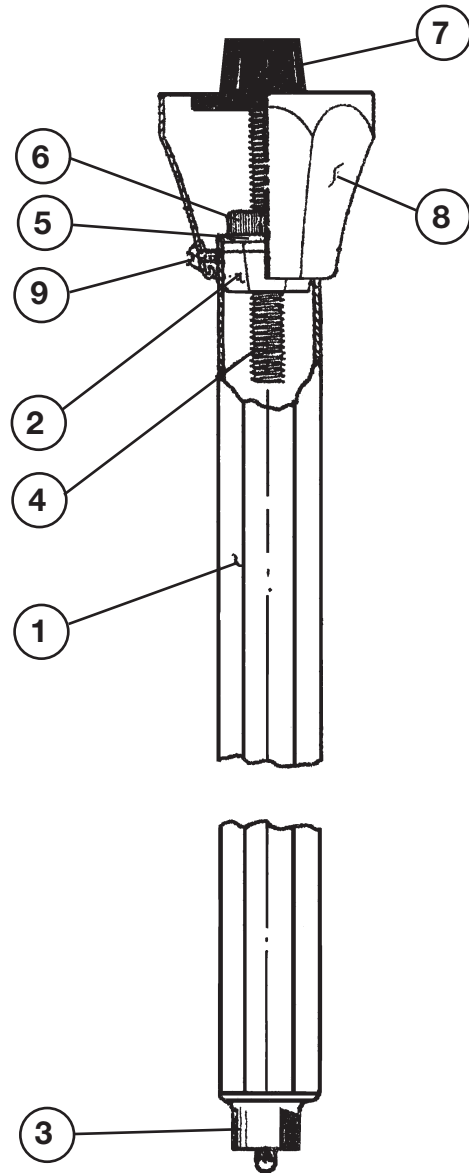

CALIFORNIA PROPOSITION 65 WARNING

WARNING: This product contains chemicals known to the State of California to cause cancer and birth defects or other reproductive harm. (California law requires this warning to be given to customers in the State of California.)

For more information: www.watts.com/prop65

Limited Warranty: Watts Regulator Co. (the "Company") warrants each product to be free from defects in material and workmanship under normal usage for a period of one year from the date of original shipment. In the event of such defects within the warranty period, the Company will, at its option, replace or recondition the product without charge.

THE WARRANTY SET FORTH HEREIN IS GIVEN EXPRESSLY AND IS THE ONLY WARRANTY GIVEN BY THE COMPANY WITH RESPECT TO THE PRODUCT. THE COMPANY MAKES NO OTHER WARRANTIES, EXPRESS OR IMPLIED. THE COMPANY HEREBY SPECIFICALLY DISCLAIMS ALL OTHER WARRANTIES, EXPRESS OR IMPLIED, INCLUDING BUT NOT LIMITED TO THE IMPLIED WARRANTIES OF MERCHANTABILITY AND FITNESS FOR A PARTICULAR PURPOSE.

The remedy described in the first paragraph of this warranty shall constitute the sole and exclusive remedy for breach of warranty, and the Company shall not be responsible for any incidental, special or consequential damages, including without limitation, lost profits or the cost of repairing or replacing other property which is damaged if this product does not work properly, other costs resulting from labor charges, delays, vandalism, negligence, fouling caused by foreign material, damage from adverse water conditions, chemical, or any other circumstances over which the Company has no control. This warranty shall be invalidated by any abuse, misuse, misapplication, improper installation or improper maintenance or alteration of the product.

Some States do not allow limitations on how long an implied warranty lasts, and some States do not allow the exclusion or limitation of incidental or consequential damages. Therefore the above limitations may not apply to you. This Limited Warranty gives you specific legal rights, and you may have other rights that vary from State to State. You should consult applicable state laws to determine your rights. **SO FAR AS IS CONSISTENT WITH APPLICABLE STATE LAW, ANY IMPLIED WARRANTIES THAT MAY NOT BE DISCLAIMED, INCLUDING THE IMPLIED WARRANTIES OF MERCHANTABILITY AND FITNESS FOR A PARTICULAR PURPOSE, ARE LIMITED IN DURATION TO ONE YEAR FROM THE DATE OF ORIGINAL SHIPMENT.**

WATTS®

Brass & Tubular Products

ISO 9001-2000
CERTIFIED

USA: 815 Chestnut St., No. Andover, MA 01845-6098; www.watts.com

Canada: 5435 North Service Rd., Burlington, ONT. L7L 5H7; www.wattscanada.ca