

Introducing the NEW **CinchClamp™** from Watts Radiant

These connections are a cinch to make.

Our new CinchClamp boldly goes where those other fittings can't – mainly into tight, hard-to-reach spaces. With a unique “tab” design, there is no need to get a tool around the entire fitting. Simply press the tab closed with the CinchTool™ and the connection is complete.

This design offers a positive mechanical connection, ensuring the RadiantPEX® is uniformly compressed against the fitting. The ratcheting CinchTool only releases when proper assembly is complete. No guess work is needed to determine if the connection has been properly made.

The unique CinchClamp design makes the new CinchTool dramatically simpler and easier to use. One tool installs all sizes from 3/8" to 1".

See an [animated introduction](http://wattsradiant.com) to CinchClamp at <http://wattsradiant.com>

Why it's a cinch:

- Ratcheting tool provides easy one-tool assembly.
- Connections can be dry-fit.
- Connections can be made with wet tubing.
- Final connections take only seconds.
- CinchTool only releases when connection is complete, ensuring a perfect connection.
- No calibration required on the CinchTool.
- Can visually verify whether connection is completed – tab of clamp is “pinched”.
- Connection rated to 160 psi @ 73°F; 100 psi @ 180°F.
- Clamp is an interlocking ring, forming a complete 360° uniform, watertight seal.
- Corrosion resistant, annealed 304 stainless steel.
- Uses ASTM F1807 brass or ASTM F2159 plastic insert/crimp fittings (plastic for potable systems only).

The CinchClamp connection system needs only one tool for all clamp sizes.

Description*	Order #	Qty	List Price
3/8" CinchClamp	81004993	10	\$3.00
	81004994	100	\$30.00
1/2" CinchClamp	81004995	10	\$3.50
	81004996	100	\$35.00
5/8" CinchClamp	81005114	10	\$4.60
	81005115	100	\$46.00
3/4" CinchClamp	81004997	10	\$4.60
	81004998	100	\$46.00
1" CinchClamp	81005001	10	\$5.80
	81005002	100	\$58.00
CinchTool	81004999	1	\$187.00

The CinchTool will install all sizes of CinchClamps.  
11" L x 3" W x 3/4" H

[www.wattsradiant.com](http://www.wattsradiant.com)

4500 E. Progress Place / Springfield, MO 65803 / 800-276-2419

 **Watts Radiant**  
Floor Heating & Snowmelting

A subsidiary of Watts Water Technologies, Inc.

# Making RadiantPEX® connections with CinchClamps™

## Product Overview

The CinchClamp should be installed in accordance to local plumbing code and practices. In addition to these standards, the following should be considered:

### Tools:

Use an approved tool such as Watts Radiant's CinchTool™ or equivalent (must be ratcheting-type tool meeting ASTM 2098 specifications). Failure to use this type of tool will result in an improper fit. Use of other tools, such as pliers, will result in an improper fit and possible leaks.

### Warning!

- Do not install CinchClamps when the air temperature is below 30°F.
- When the CinchTool's jaws are closed, the gap between the jaws must be less than 1/16". Any gap greater than 1/16" is a sign of tool wear. Discard the tool and replace it immediately. Use of an out-of-spec tool will cause leaks.
- Never use a CinchTool to remove a CinchClamp. Damage to the tool's calibration may result. Use a pair of pliers or vice grips.

## The Connection

Make sure the RadiantPEX has a clean, square end. Use a PEX Tube Cutter to ensure the PEX does not deform while cutting.

### Step 1:

Slide the CinchClamp over the end of the PEX. Allow enough room to allow for the fitting to be inserted.

### Step 2:

Insert the fitting into the tube end making sure the tube is fully sealed over the fitting. Allow for 1/8" of clearance between the CinchClamp and the fitting.

**Warning: Never use CinchClamps on PEX fittings made from copper. Leaks may result. Use only ASTM brass or polysulfone crimp insert fittings.**

### Step 3:

Position the open jaws of the CinchTool over the tabs of the CinchClamp and squeeze. The ratchet effect of the CinchTool will not allow for an improper connection. The CinchTool will release automatically when the connection is complete.

### Step 4:

Verify the connection is secure by visually checking the CinchTab. The tab should be shaped as shown below.

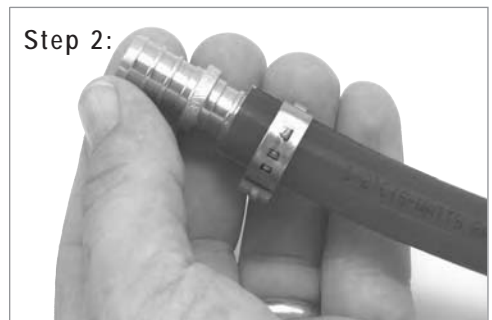
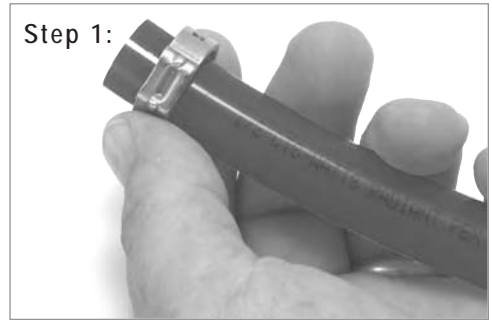

Description*	Order #	Qty.	Description*	Order #	Qty.
3/8" CinchClamp	81004993	10	3/4" CinchClamp	81004997	10
	81004994	100		81004998	100
1/2" CinchClamp	81004995	10	1" CinchClamp	81005001	10
	81004996	100		81005002	100
5/8" CinchClamp	81005114	10	CinchTool™	81004999	1
	81005115	100			