

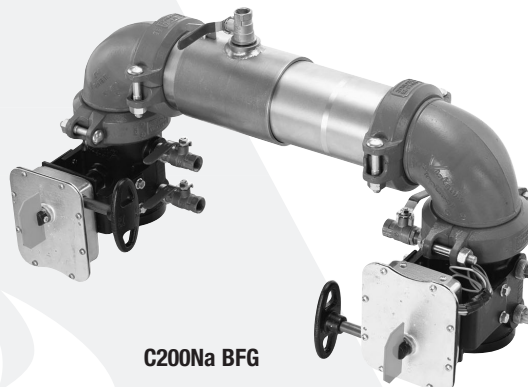

# Colt™ Series C200Na

## Double Check Valve Assemblies

Sizes: 2½" – 6" (65 – 150mm)



C200Na BFG

### Features

- Extremely Compact Design
- 70% Lighter than Traditional Designs
- 304 (Schedule 40) Stainless Steel Housing & Sleeve
- Groove Fittings Allow Integral Pipeline Adjustment
- Patented Bi-Link Check Provides Lowest Pressure Loss
- Unmatched Ease of Serviceability
- Available with Grooved Butterfly Valve Shutoffs
- Available for N Pattern Installations
- Replaceable Check Disc Rubber

The Colt C200Na Double Check Valve Assemblies are used to prevent backflow of pollutants, that are objectionable but not toxic, from entering the potable water supply system. The Colt C200Na may be installed under continuous pressure service and may be subjected to backpressure. The Colt C200Na consists of two independently operating check valves, two shutoff valves, and four test cocks. For use in non-health hazard applications.

### Specifications

The Colt C200Na Double Check Valve Assemblies shall consist of two independent Bi-Link Check modules within a single housing, sleeve access port, four test cocks and two drip tight shutoff valves. Bi-Link Checks shall be removable and serviceable, without the use of special tools. The housing shall be constructed of 304 (Schedule 40) stainless steel pipe with groove end connections. Bi-Link Checks shall have reversible elastomer discs and in operation shall produce drip tight closure against the reverse flow of liquid caused by backpressure or backsiphonage. Assembly shall be a Colt C200Na as manufactured by the Ames Company.

---

Job Name \_\_\_\_\_ Contractor \_\_\_\_\_

Job Location \_\_\_\_\_ Approval \_\_\_\_\_

Engineer \_\_\_\_\_ Contractor's P.O. No. \_\_\_\_\_

Approval \_\_\_\_\_ Representative \_\_\_\_\_

*Ames product specifications in U.S. customary units and metric are approximate and are provided for reference only. For precise measurements, please contact Ames Technical Service. Ames reserves the right to change or modify product design, construction, specifications, or materials without prior notice and without incurring any obligation to make such changes and modifications on Ames products previously or subsequently sold.*

## Configurations

- Horizontal
- Vertical up
- “N” pattern horizontal

## Materials

- Housing & Sleeve: 304 (Schedule 40) Stainless Steel
- Elastomers: EPDM, Silicone and Buna ‘N’
- Bi-Link Checks: Noryl®, Stainless Steel
- Check Discs: Reversible EPDM
- Test Cocks: Bronze Body Nickel Plated
- Pins & Fasteners: 300 Series Stainless Steel
- Springs: Stainless Steel

## Available Models

Suffix:

NRS - non-rising stem resilient seated gate valves

OSY - UL/FM outside stem and yoke resilient seated gate valves

BFG - UL/FM grooved gear operated butterfly valves with tamper switch

\*OSY FxG - Flanged inlet gate connection and grooved outlet gate connection

\*OSY GxF - Grooved inlet gate connection and flanged outlet gate connection

\*OSY GxG - Grooved inlet gate connection and grooved outlet gate connection

Available with grooved NRS gate valves - consult factory\*

Post indicator plate and operating nut available - consult factory\*

\*Consult factory for dimensions

## Pressure — Temperature

Temperature Range: 33°F – 110°F (5°C – 43°C)

Maximum Working Pressure: 175psi (12.06 bar)

## Dimensions — Weights

### C200Na

| SIZE (DN) |     | DIMENSIONS |     |     |     |     |        | WEIGHT |      |      |      |     |     |     |     |
|-----------|-----|------------|-----|-----|-----|-----|--------|--------|------|------|------|-----|-----|-----|-----|
|           |     | G          | H   | I   | J   | P   | C200Na |        |      |      |      |     |     |     |     |
|           |     |            |     |     |     |     |        | NRS    |      | OSY  |      |     |     |     |     |
| in.       | mm  | in.        | mm  | in. | mm  | in. | mm     | lbs.   | kgs. | lbs. | kgs. |     |     |     |     |
| 2½        | 65  | 29⅛        | 738 | 22  | 559 | 15½ | 393    | 8⅓⅓    | 223  | 9⅓⅓  | 234  | 123 | 56  | 133 | 60  |
| 3         | 80  | 30¼        | 768 | 22¾ | 578 | 17⅞ | 435    | 9¾     | 233  | 10½  | 267  | 144 | 65  | 158 | 72  |
| 4         | 100 | 33         | 838 | 24  | 610 | 18½ | 470    | 9⅓⅓    | 252  | 11⅓⅓ | 284  | 184 | 83  | 184 | 83  |
| 6         | 150 | 16         | 406 | 5½  | 140 | 44¾ | 1137   | 13⅓⅓   | 332  | 15   | 381  | 314 | 142 | 336 | 152 |

Note: For 2½" – 6" horizontal/vertical installation, send for literature ES-A-C200/C200N.

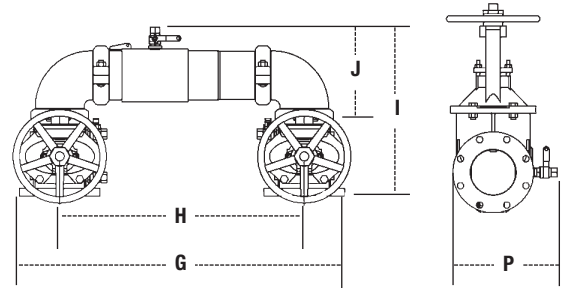

### C200NaBFG

| SIZE (DN) |     | DIMENSIONS |      |     |     |      |           | WEIGHT |      |      |      |     |    |
|-----------|-----|------------|------|-----|-----|------|-----------|--------|------|------|------|-----|----|
|           |     | G          | H    | I   | J   | P    | C200NaBFG |        |      |      |      |     |    |
| in.       | mm  | in.        | mm   | in. | mm  | in.  | mm        | lbs.   | kgs. | lbs. | kgs. |     |    |
| 2½        | 65  | 29⅞        | 759  | 22  | 559 | 14⅓⅓ | 379       | 8⅓⅓    | 223  | 9    | 229  | 64  | 29 |
| 3         | 80  | 30⅓⅓       | 779  | 22¾ | 578 | 15⅓⅓ | 392       | 9⅓⅓    | 233  | 9½   | 241  | 67  | 30 |
| 4         | 100 | 31⅓⅓       | 811  | 24  | 610 | 16¼  | 412       | 9⅓⅓    | 252  | 10   | 254  | 84  | 38 |
| 6         | 150 | 43⅓⅓       | 1097 | 33¾ | 857 | 19⅓⅓ | 500       | 13⅓⅓   | 332  | 10½  | 267  | 157 | 71 |

Note: For 2½" – 6" horizontal/vertical installation, send for literature ES-A-C200/C200N.

Noryl® is a registered trademark of General Electric Company.

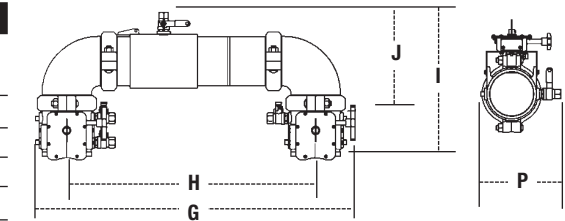

# Approvals



For additional approval information please contact the factory or visit our website at [www.amesfirewater.com](http://www.amesfirewater.com)

## Capacity

UL/FM Certified Flow Characteristics

Flow characteristics collected using butterfly shutoff valves.

See literature S-Colt-200/300 for gate valve flow characteristics

\* = Rated Flow \*\* = UL Tested

----- N - Pattern

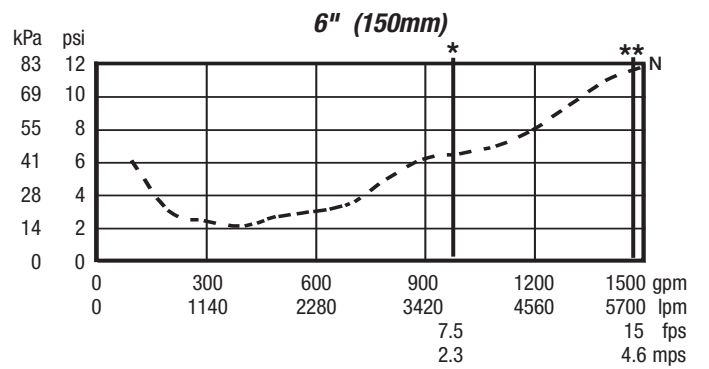
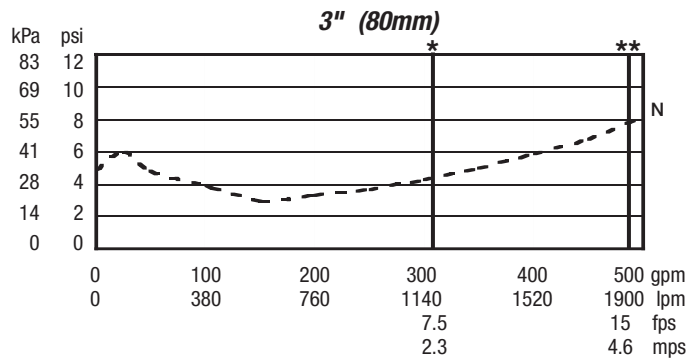
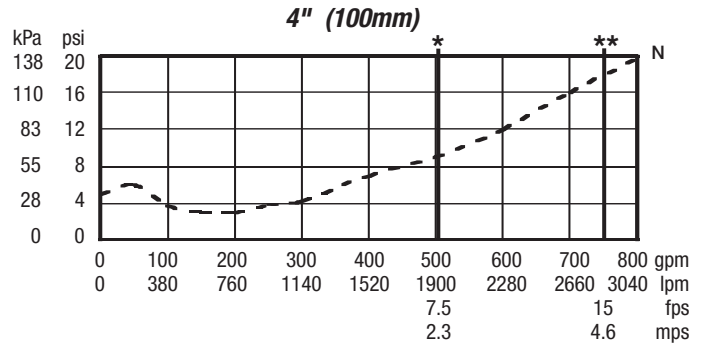
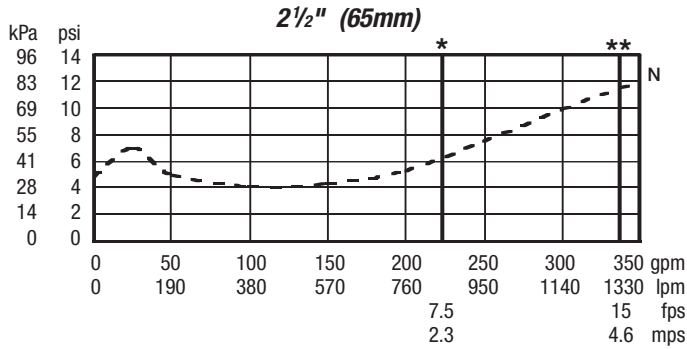

**IMPORTANT: INQUIRE WITH GOVERNING AUTHORITIES FOR LOCAL INSTALLATION REQUIREMENTS**

For additional information, visit our web site at: [www.amesfirewater.com](http://www.amesfirewater.com)



[www.amesfirewater.com](http://www.amesfirewater.com)



A Division of Watts Water Technologies, Inc. **USA: Backflow-** 1427 N. Market Blvd • Suite #9 • Sacramento, CA 95834 • T: 916-928-0123 • F: 916-928-9333

**Control Valves-** 18550 Hansen Road • Houston, TX 77075 • T: 713-943-0688 • F: 713-944-9445

**Canada:** 5435 North Service Rd. • Burlington, ONT. L7L 5H7 • T: 905-332-4090 • F: 905-332-7068

ES-A-C200Na 0836

©Ames Fire & Waterworks 2008