

**For Commercial & Residential**

Job Name \_\_\_\_\_ Contractor \_\_\_\_\_  
 Job Location \_\_\_\_\_ Approval \_\_\_\_\_  
 Engineer \_\_\_\_\_ Contractor's P.O. No. \_\_\_\_\_  
 Approval \_\_\_\_\_ Representative \_\_\_\_\_  
 Tag \_\_\_\_\_

# BFD-420-SO

## Sanitary Floor Drain With 8" Round Top, Side Outlet



**BFD-420-SO**

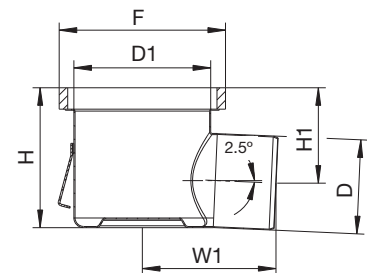

### Specification

BLÜCHER BFD-420-SO AISI Type 304 stainless steel sanitary floor drain with 8"(200) round top, 1/8"(3) grating (standard), and side outlet.

### Dimensions

Model No.	Global Part #	Pipe Size		Top Size		H	H1	W1
		D	D1	F	H			
BFD-423-SO	726.502.075	3"(75)	6"(160)	7 5/8"(195)	6 7/16"(164)	5"(127)		9 15/16"(253)
*BFD-424-SO	726.502.110	4"(110)	6"(160)	7 5/8"(195)	6 7/16"(164)	4 7/16"(112)		6 3/16"(156)

Optional Gratings			
	Suffix	Description	
	-None	1/8" (Standard)	<input type="checkbox"/>
	-LG	Ladder	<input type="checkbox"/>
	-MG	Mesh	<input type="checkbox"/>
	-SG	Slot	<input type="checkbox"/>

Please see ES-B-Commercial/Industrial Round Gratings for more information.

Options (Select One Or More)		
Suffix	Description	
-150	1/2 Grate (Standard Grating)	<input type="checkbox"/>
-175	3/4 Grate (Standard Grating)	<input type="checkbox"/>
-316	Type 316 Stainless Steel	<input type="checkbox"/>
-B	Sediment Basket	<input type="checkbox"/>
-P	Stainless Steel P-Trap	<input type="checkbox"/>
-SB	Sand Bucket	<input type="checkbox"/>
-TPT	Trap Primer Tapping	<input type="checkbox"/>
-VP	Grate Secured w/Vandal Proof Screws	<input type="checkbox"/>

### NOTICE

The information contained herein is not intended to replace the full product installation and safety information available or the experience of a trained product installer. You are required to thoroughly read all installation instructions and product safety information before beginning the installation of this product.

### Approvals



Compliance with NSF/ANSI/3-A 14159-1-Hygiene Requirements for the Design of Meat and Poultry Processing Equipment



\* Product is certified to the uniform plumbing code ASME A112.6.3



**A WATTS Brand**