

For Commercial & Residential Applications

Job Name _____

Contractor _____

Job Location _____

Approval _____

Engineer _____

Contractor's P.O. No. _____

Approval _____

Representative _____

Series E810, E830, E840

Tub and Shower Faucets

Features

- Classic European design
- Polished chrome finish
- Washerless Cartridge

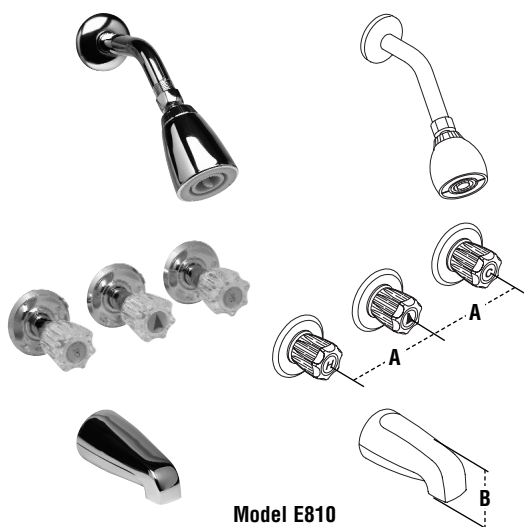

Model E810

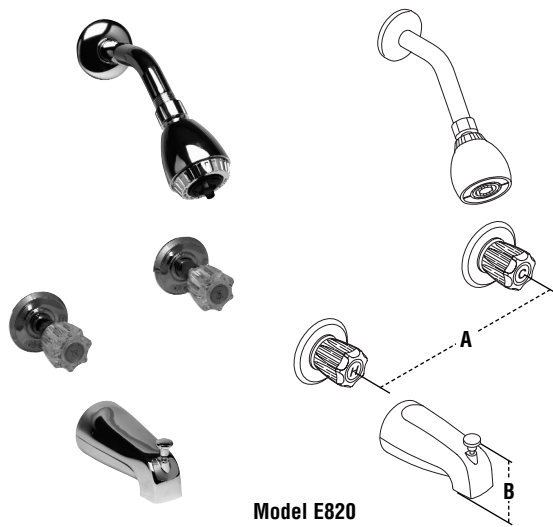

Model E820

MODEL	✓ TO SUBMIT	DESCRIPTION	DIMENSIONS			
			A		B	
			in	mm	in	mm
E810		Tub and shower combination, triple acrylic handles with regular spout, head, arm and escutcheons. Washerless cartridge	4	10	5 ⁹ / ₁₆	132
E820		Tub and shower combination, double acrylic handles with diverter spout, head, arm and escutcheons. Washerless cartridge	9 ¹ / ₈	232	5 ⁹ / ₁₆	132
E830		Shower only, double acrylic handles with head, arm and escutcheons. Washerless cartridge	9 ¹ / ₈	232	—	—
E840		Tub only, double acrylic handles with regular spout. Washerless cartridge	9 ¹ / ₈	232	5 ⁹ / ₁₆	132



815 Chestnut Street • N. Andover, MA 01845
 Tel: 978.688.1811 Fax: 978.794.1848
 www.wattsbrass-tubular.com

Watts product specifications in U.S. customary units and metric are approximate and are provided for reference only. For precise measurements, please contact Watts Technical Service. Watts reserves the right to change or modify product design, construction, specifications, or materials without prior notice and without incurring any obligation to make such changes and modifications on Watts products previously or subsequently sold.