

Dimensions

High Purity Pipe

Available in Polypropylene or PVDF

Pipe

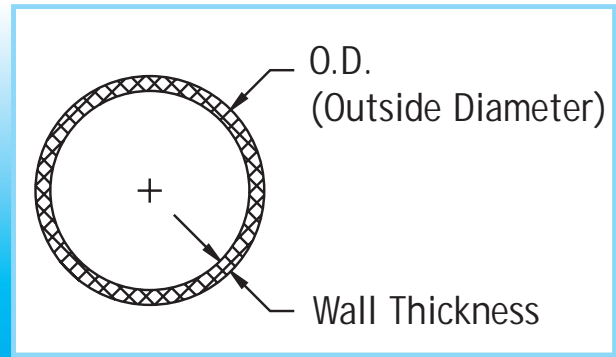

Schedule 80	Average OD	Wall Thickness	Weight per Stick		Sticks per Bundle	
			PP	PVDF	PP	PVDF
½	0.84	0.147	1.5	2.67	10	10
¾	1.05	0.154	1.8	3.50	10	10
1	1.315	0.179	2.9	5.25	10	10
1½	1.900	0.200	4.6	8.50	10	5
2	2.375	0.218	5.9	12.00	10	5

Schedule 40	Average OD	Wall Thickness	Weight per Stick		Sticks per Bundle	
			PP	PVDF	PP	PVDF
½	0.84	0.109	2.25		10	
¾	1.05	0.113	3.00		10	
1	1.315	0.133	4.25		10	
1½	1.900	0.145	7.00		5	
2	2.375	0.154	9.75		5	

230 PSI	Average OD	Wall Thickness	Weight per Stick		Sticks per Bundle	
			PP	PVDF	PP	PVDF
½	0.84	0.09	2.00		10	
¾	1.05	0.09	2.25		10	
1	1.315	0.09	3.25		10	
1½	1.900	0.113	5.00		5	
2	2.375	0.113	8.50		5	

High Purity Fittings Socket Fusion

Available in Polypropylene or PVDF

CLS Coupling*

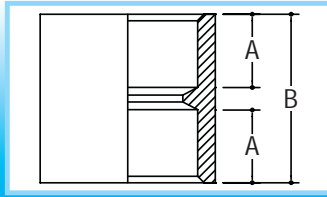

Size:	A	B	C	D	E	WEIGHT PP	WEIGHT PVDF
½	.65	1.60				.675	1.36
¾	.65	1.60				.775	1.56
1	.70	1.60				.925	1.86
1½	.88	2.07				1.950	3.92
2	.90	2.07				2.460	4.94

RCLS Reducing Coupling*

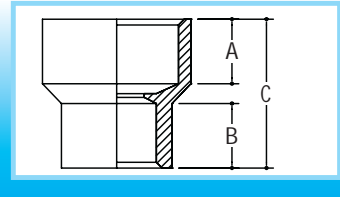

Size:	A	B	C	D	E	WEIGHT PP	WEIGHT PVDF
¾ x ½	.65	1.60				.675	1.36
1 x ½	.70	1.60				.875	1.70
1 x ¾	.70	1.60				.825	1.66
1½ x ½	.88	2.07				.880	1.82
1½ x ¾	.88	2.07				.880	1.99
1½ x 1	.88	2.07				1.800	3.62
2 x 1½	.90	2.07				2.210	4.52
2 x 1	.90	2.07				2.250	5.60
2 x ½	.90	2.07				2.500	5.60
2 x ¾	.90	2.07				2.500	5.60

45E 45 Elbow*

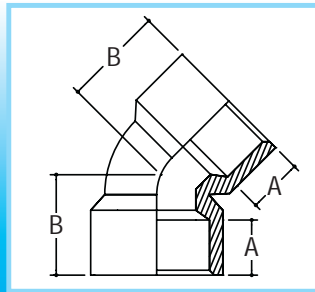

Size:	A	B	C	D	E	WEIGHT PP	WEIGHT PVDF
½	.65	1.25				.85	1.81
¾	.65	1.25				1.10	2.11
1	.70	1.25				1.60	2.61
1½	.88	1.65				2.95	4.52
2	.90	1.75				4.10	6.03

90E 90 Elbow*

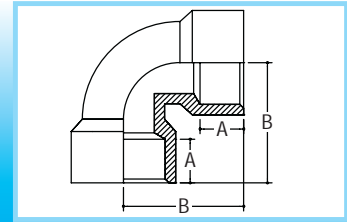

Size:	A	B	C	D	E	WEIGHT PP	WEIGHT PVDF
½	.65	1.63				.85	1.71
¾	.65	1.80				1.10	2.21
1	.70	1.92				1.60	3.22
1½	.88	2.41				2.95	5.93
2	.90	2.68				4.10	8.24

RB Reducing Bushing*

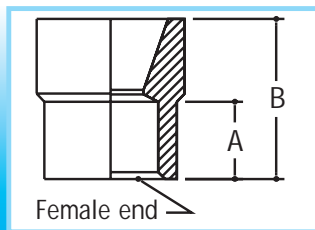

Size:	A	B	C	D	E	WEIGHT PP	WEIGHT PVDF
¾ x ½	.65	1.45				.695	1.36
1 x ½	.65	1.45				.850	1.70
1 x ¾	.65	1.45				.825	1.66
1½ x ½	.60	1.70				1.850	1.94
1½ x ¾	.65	1.62				1.850	1.97
1½ x 1	1.70	1.63				1.800	3.62
2 x ½	.60	2.71				2.500	4.50
2 x ¾	.65	2.63				2.500	4.50
2 x 1	.70	2.64				2.500	4.50
2 x 1½	.88	1.89				2.500	4.52

90T Tee*

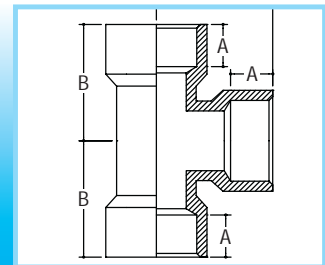

Size:	A	B	C	D	E	WEIGHT PP	WEIGHT PVDF
½	.65	1.62				1.15	2.31
¾	.65	1.79				2.10	4.22
1	.70	1.93				2.10	4.22
1½	.88	2.44				4.00	8.04
2	.90	2.72				5.50	11.06

* These fittings also available in Standardline

Socket Fusion High Purity Fittings

Available in Polypropylene or PVDF

CAP Cap*

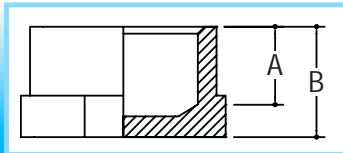

Size:	A	B	C	D	E	WEIGHT PP	WEIGHT PVDF
½	.65	1.00				.650	1.31
¾	.65	1.00				.750	1.51
1	.70	1.00				.875	1.76
1½	.88	1.28				1.870	3.76
2	.90	1.28				2.510	5.05

FLG Flange*

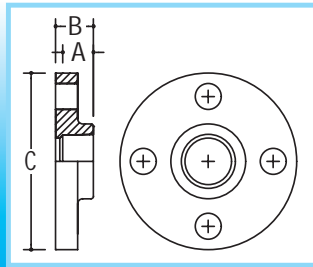

Size:	A	B	C	D	E	WEIGHT PP	WEIGHT PVDF
½	.63	.81	3.52				
¾	.65	.90	3.89				
1	.70	.92	4.25				
1½	.88	1.11	5.00				
2	.90	1.38	5.98				

BACKUP Backup Ring*

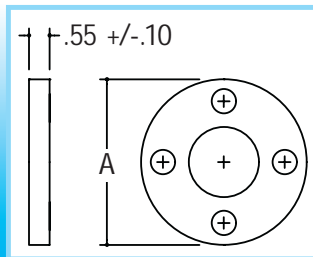

Size:	A	150# ANSI Pattern Holes	WEIGHT PP	WEIGHT PVDF
½	3.50	4		
¾	4.00	4		
1	4.25	4		
1½	5.00	4		
2	6.00	4		

R90T Reducing Tee*

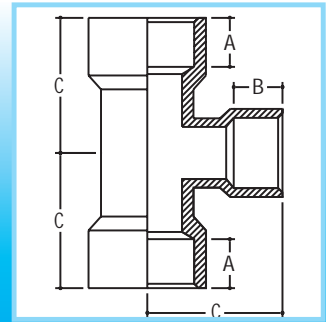

Size:	A	B	C	D	E	WEIGHT PP	WEIGHT PVDF
¾ x ½	.65	.65	1.79			1.50	2.81
1 x ½	.70	.65	1.93			1.95	3.52
1 x ¾	.70	.65	1.93			1.95	3.92
1½ x 1	.88	.70	2.44			3.65	8.70
2 x 1½	.90	.88	2.72			5.45	10.95

MA Male Adapter*

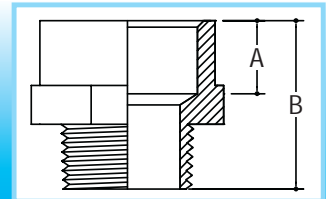

Size:	A	B	C	D	E	WEIGHT PP	WEIGHT PVDF
½	.65	1.60				.675	1.36
¾	.65	1.60				.775	1.56
1	.70	1.60				.975	1.96
1½	.88	2.07				1.970	3.96
2	.90	2.07				2.620	5.27

FA Female Adapter*

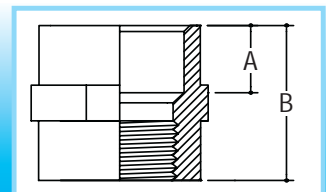

Size:	A	B	C	D	E	WEIGHT PP	WEIGHT PVDF
½	.65	1.60				.750	1.51
¾	.65	1.60				1.000	2.01
1	.70	1.60				1.175	2.36
1½	.88	2.07				2.320	4.66
2	.90	2.07				2.920	5.87
½ x ¼	.65	1.60				.875	1.76
½ x ⅜	.65	1.60				.850	1.71

* These fittings also available in Standardline

High Purity Fittings Socket Fusion

Available in Polypropylene or PVDF

UNION Union*

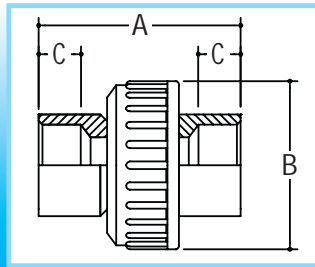

Size:	A	B	C	D	E	WEIGHT PP	WEIGHT PVDF
½	3.33	2.00	.65			1.65	3.32
¾	3.33	2.43	.65			2.15	4.32
1	3.33	2.81	.70			2.70	5.43
1½	3.88	3.70	.88			5.40	10.85
2	3.88	4.34	.90			6.95	13.97

BVTHD Threaded Ball Valve*

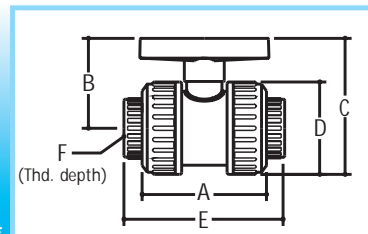

Size:	A	B	C	D	E	F	WEIGHT PP	WEIGHT PVDF
½	3.00	1.89	2.89	2.00	3.68	.69	1.4	2.81
¾	3.45	2.49	3.70	2.43	4.45	.79	1.8	3.62
1	3.74	2.58	3.98	2.80	4.88	.88	2.2	4.42
1½	4.85	3.52	5.54	4.04	6.42	1.18	4.4	8.84
2	5.98	4.14	6.77	5.27	7.41	1.18	5.5	11.06

DV Diaphragm Valve

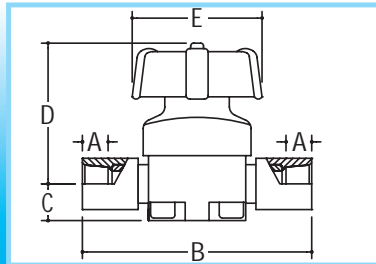

Size:	A	B	C	D	E	WEIGHT PP	WEIGHT PVDF
½	.65	6.79	1.02	3.94	3.55	21.0	27.3
¾	.65	7.57	1.02	3.94	3.55	21.7	25.6
1	.70	7.87	1.02	3.94	3.55	21.7	26.3
1½	.88	10.02	1.58	4.96	4.49	42.0	90.8
2	.90	11.17	1.58	6.15	5.52	72.0	59.6

BC Ball Check

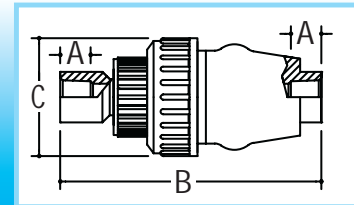

Size:	A	B	C	D	E	WEIGHT PP	WEIGHT PVDF
½	.70	4.57	1.99			2.8	4.90
¾	.70	5.09	2.44			4.3	8.00
1	.70	5.37	2.80			6.5	11.75
1½	.92	6.36	3.78			15.2	27.00
2	.92	7.20	4.21			21.0	36.00

BV Ball Valve*

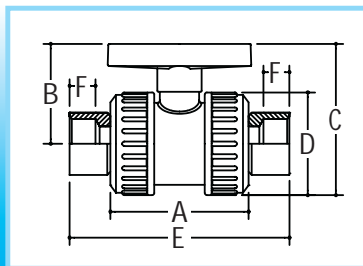

Size:	A	B	C	D	E	F	WEIGHT PP	WEIGHT PVDF
½	3.00	1.89	2.89	2.00	5.36	.65	1.4	2.81
¾	3.45	2.49	3.70	2.43	5.92	.65	1.8	3.62
1	3.74	2.58	3.98	2.80	6.14	.70	2.2	4.42
1½	4.85	3.52	5.54	4.04	7.14	.88	4.4	8.84
2	5.98	4.14	6.77	5.27	8.08	.90	5.5	11.06

NV Needle Valve

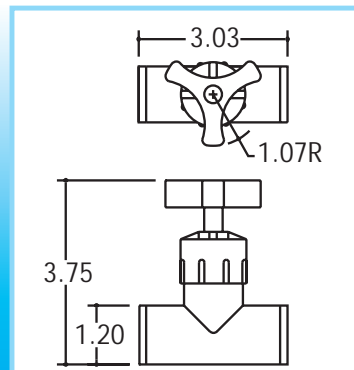

Size:	A	B	C	D	E	WEIGHT PP	WEIGHT PVDF
¼	F.I.P.						
½	F.I.P.						
¾	F.I.P.						
1	S.F.						

* These fittings also available in Standardline

Socket Fusion High Purity Fittings

Available in Polypropylene or PVDF

HOSE

Hose Bibb
 $\frac{3}{4}$ " Soc x $\frac{3}{4}$ " - 11.5
 N.R.Hose Thread

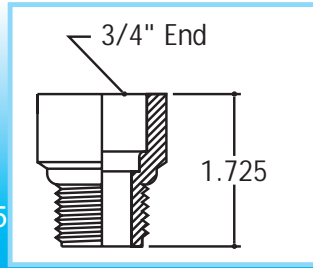

HB

Hose Barb

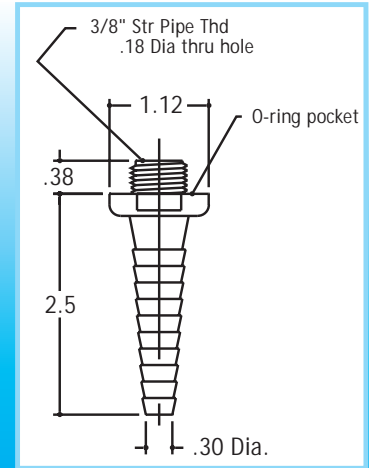

MM

Metric Adapter

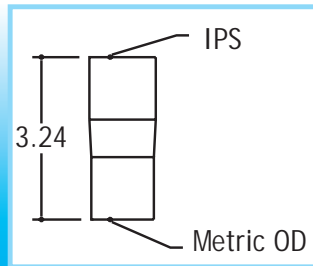

IPS x Metric Size:	A	B	C	D	WEIGHT PP	WEIGHT PVDF
$\frac{1}{2}$ x 20mm (d)						
$\frac{3}{4}$ x 24mm (d)						
1 x 32mm (d)						
$1\frac{1}{2}$ x 50mm (d)						
2 x 63mm (d)						