



PRESS-ALL TOOLS

Radiant PEX-AL

Ask for ALEX.



15" PressAll tool, 15" jaws and 15" crimping jaws shown.

A money-saving tool.

Both Press and Crimp jaws fit our new PressAll tool.
And both sets of jaws fit the CrimpAll tool, as well. No matter which tool you own, you can simply buy a jaw set to double your tool's capability.

INTERCHANGEABILITY. Big word. Simple concept.

Watts Radiant introduces one tool to fit two sets of interchangeable jaws. Use your CrimpAll or PressAll tool to make both types of connection. Two types of pipe, two types of fittings, multiple sizes... one tool does them all!

Codes, Listings, and Standards.

Radiant PEX-AL tubing and Press fittings are manufactured in accordance with American Standard Testing Methods (ASTM) F-1281, are tested and listed by the National Sanitation Foundation (NSF-PW Standards 14 and 61 and NSF-rfh), and carry the UPC certification mark, as approved by the International Association of Plumbing and Mechanical Officials (IAPMO).



Both the 15" and the 19" tool kits contain an adjustable wrench and jaw changing tool. Instructions for adjustment, jaw replacement and making Press connections are permanently labelled inside the lid.



Tools and Accessories

Radiant PEX-AL Press Tools		Order #	Model #	Pkg	Wt	UPC
15" Manual Pressing Tool Kit w/ 1/2", 5/8", 3/4" jaws		81008140	RLPA-0612-K1	1	6 lb	840213083922
19" Manual Pressing Tool Kit w/ 1/2", 5/8", 3/4", 1" jaws		81008142	RLPA-0624-K2	1	8 lb	840213083939
15" Press Tool, Extra Jaws Kit - 1/2", 5/8", 3/4"		81008426	RLPAJ19-K1	1	3 lb	840213083984
19" Press Tool, Extra Jaws Kit - 1/2", 5/8", 3/4", 1"		81008427	RLPAJ19-K2	1	3 lb	840213084035
Radiant PEX Crimp Tools		Order #	Model #	Pkg	Wt	UPC
15" CrimpAll Tool, Extra Jaws Kit - 3/8", 1/2", 5/8", 3/4"		81009022	PCCRT-15K1	1	3 lb	840213084363

15" PressAll™ Tool Kit; 19" PressAll™ Tool Kit

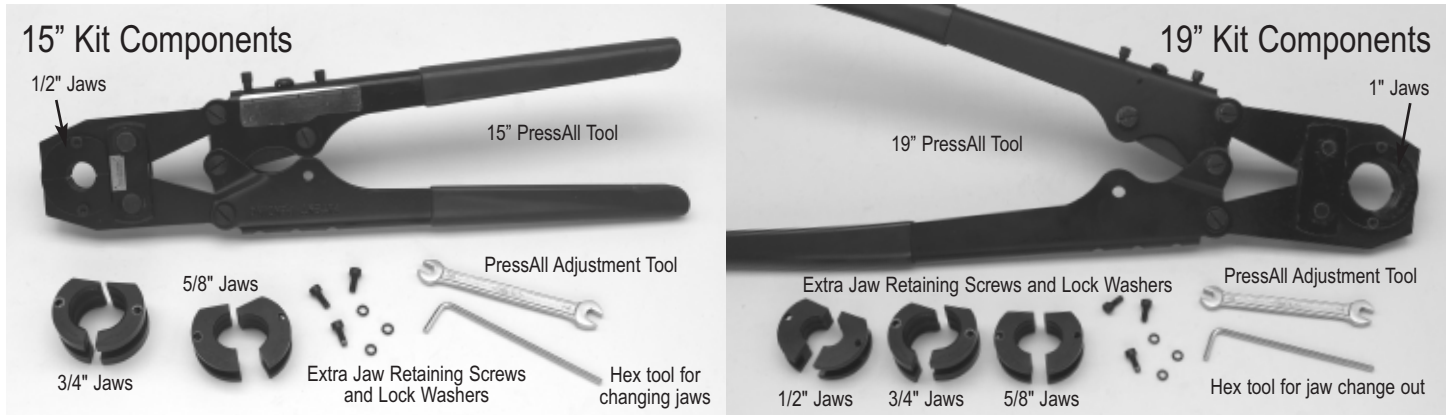

PressAll Jaw Installation



PressAll Tool Adjustment



Crescent Wrench (Included in kit)

Set Screw

Loosen before each adjustment.
Tighten after each adjustment.

Completing a PressAll Fitting

1. Cut a clean, square end to the tube.
2. Use the Reamer tool to shape and prep the tubing.
3. Make sure the Press sleeve is seated in the plastic base of the connection with the view ports against the plastic base.
4. Slide the RadiantPEX-AL tubing onto the fitting until the tubing visibly fills the view port.
5. Place the Press fitting into one side of the jaws.
6. Close the jaws firmly. Tool will stop automatically when complete.
7. See specific tool instruction sheet for maintenance information.

Uncompleted Press connection



Completed Press connection

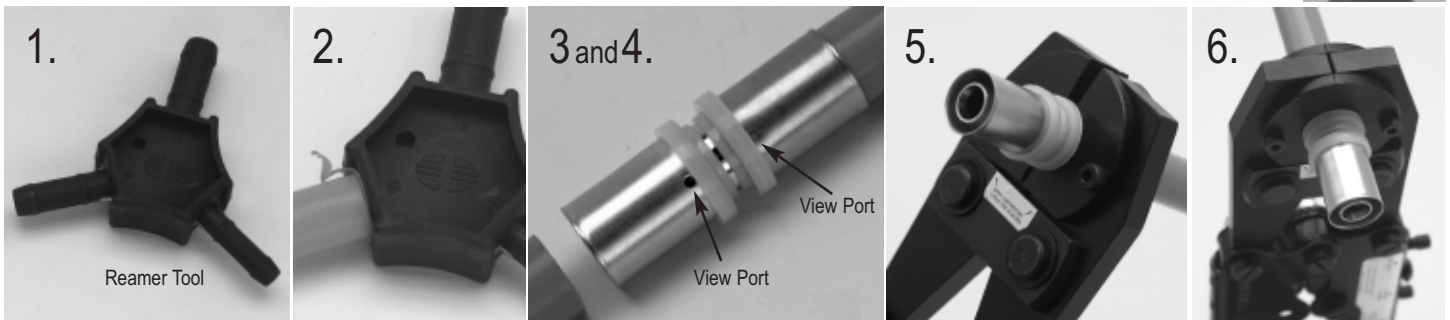

 **WattsRadiant**
Floor Heating & Snowmelting
A subsidiary of Watts Water Technologies, Inc.

In the United States

Watts Radiant, Inc.
4500 Progress Place
Springfield, MO 65803

1-800-276-2419 toll-free
417-864-6108 phone
417-864-8161 fax
www.wattsradiant.com

In Canada

Watts Industries-Canada
5435 North Service Road
Burlington, ON L7L 5H7
1-888-208-8927 toll-free phone
905-332-4090 phone
1-888-882-1979 toll-free fax
905-332-7068 fax
www.wattscanada.ca