

For Commercial And Industrial Applications

Job Name _____

Contractor _____

Job Location _____

Approval _____

Engineer _____

Contractor's P.O. No. _____

Approval _____

Representative _____

Tag _____

Pipe Adapters

Specification:

BLÜCHER Pipe AISI Type 316L (standard) stainless steel pipe-system, with Push-Fit socket connections with EPDM (standard) sealing ring. All BLÜCHER PIPE to be treated with pickling and passivation finish process.

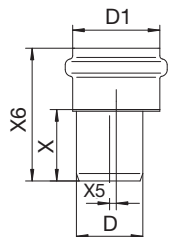
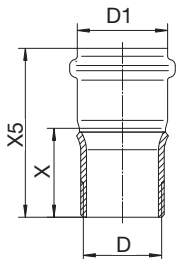
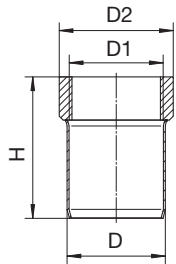

Female Adaptor Dimensional Chart

MODEL NO.	D	D1	H	H5
FA-1-1/2x1-1/4-316	1-1/2"(40)	1-1/4"(32)	2 13/16"(70)	1-13/16"(45)
FA-1-1/2x1-1/2-316	1-1/2"(40)	1-1/2"(40)	2-7/8"(73)	2-1/4"(57)
FA-2x1-316	2"(50)	1"(25)	3-11/16"(93)	1-5/8"(40)
FA-2x1-1/4-316	2"(50)	1-1/4"(32)	2-7/8"(72)	1-15/16"(48)
FA-2x1-1/2-316	2"(50)	1-1/2"(40)	2-7/8"(72)	2-5/16"(58)
FA-2x2-316	2"(50)	2"(50)	3-1/16"(77)	2-11/16"(67)

Male Adaptor Dimensional Chart

MODEL NO.	D	X	X5
MA-1-1/4x2-316	1-1/4"(32)	3-7/8"(97)	2"(50)
MA-1-1/2x2-316	1-1/2"(40)	3-7/8"(97)	2-1/16"(52)
MA-2x2-316	2"(50)	3-7/8"(97)	2-1/16"(52)

Side Inlet Adaptor Dimensional Chart

MODEL NO.	D	X	X5	X6
CSIA-1-1/4x2-316	1-1/4"(32)	2-1/16"(52)	-	3-15/16"(99)
ESIA-1-1/2x2-316	1-1/2"(40)	1-3/4"(43)	3/16"(4)	3-3/16"(80)

NOTICE

The information contained herein is not intended to replace the full product installation and safety information available or the experience of a trained product installer. You are required to thoroughly read all installation instructions and product safety information before beginning the installation of this product.

Approvals



* Product is certified to the uniform plumbing code ASME A112.6.3



A WATTS Brand